

Project:	
Type:	
Catalog #:	

### STANDARD



### OPTIONAL

### ILLUMINATION

- Long lasting, energy efficient white LED exit sign illumination.
- Single or double face configuration.
- Two 6V 5.3W adjustable white LED lamp heads.

### ELECTRICAL

- Dual 120/277 voltage standard.
- Charge rate/power "ON" LED indicator light and push-to-test switch for mandated code compliance testing.
- 6V sealed lead acid, maintenance-free, rechargeable battery.
- LVD (low voltage disconnect) prevents battery from deep discharge.
- Internal solid-state transfer switch automatically connects the internal battery to LED board and LED lamp heads for minimum 120 minute emergency illumination.
- Fully automatic solid-state, two rate charger initiates battery charging to recharge a discharged battery in 24 hours.

### MOUNTING

- Mounting canopy included for top or end mount.
- Universal K/O pattern on back plate for wall mount.

### HOUSING

- Durable 20-gauge steel construction.
- White or black finish.

### ORDERING INFORMATION

### OPTIONS

- RC: Remote capacity of up to 10.0 watts.

### WARRANTY / LISTING

- Five year warranty on all electronics and housing. Battery pro rated for two years.
- Meets UL924, NFPA 101 Life Safety Code, NEC, OSHA, Local and State Codes.
- UL Listed for damp locations (20°C – 50°C).

### DIMENSIONS

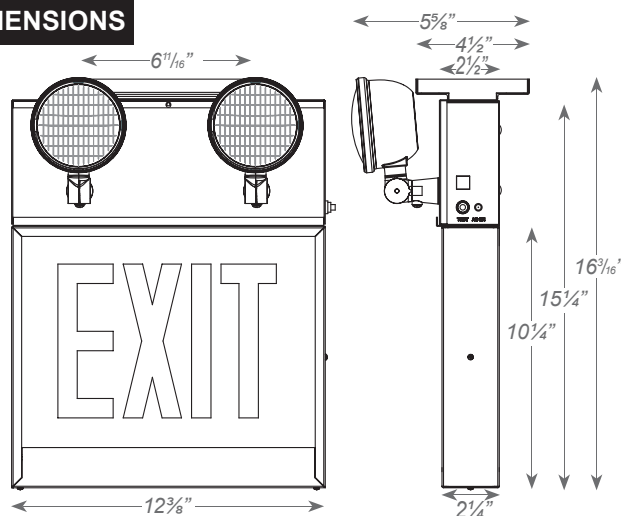

Sample Part Number: CALEDXTEU-1-R-W-NA

MODEL	No. of FACES	LETTER	HOUSING	OPTIONS	DIRECTIONAL ARROW			
CALEDXTEU	1	Single Face	R	Red	W	White	RC	Remote Capacity
	2	Universal Single/Double Face	B	Black				
					NA	Exit No Arrow	SW-LA <sup>1</sup>	Stairs Left Arrow
					DA	Exit Double Arrow	SW-NA	Stairs No Arrow
					RA <sup>1</sup>	Exit Right Arrow	SW-DA	Stairs Double Arrow
					LA <sup>1</sup>	Exit Left Arrow	SW-RA <sup>1</sup>	Stairs Right Arrow
					LARA <sup>2</sup>	Exit Left/Right Arrow	SW-LARA <sup>2</sup>	Stairs Left/Right Arrow

#### NOTES:

<sup>1</sup> Available in single face configuration only.

<sup>2</sup> Available in double face configuration only.

<b>Project:</b>	
<b>Type:</b>	
<b>Catalog #:</b>	

## ELECTRICAL INFORMATION

CATALOG NUMBER	INPUT WATTS (W)		INPUT AMPS (A)	
	120V	277V	120V	277V
CALEDXTEU	12	13	0.12A	0.06A
CALEDXTEU-RC	12	13	0.12A	0.06A

## REMOTE LAMP COMPATIBILITY

MODEL NUMBER	BATTERY	REMOTE CAPACITY	COMPATIBLE REMOTE HEAD FAMILY				
			RHLED	MRHLED	RH16LED	SRHLED (6V)	SRHLED
CALEDXTEU-RC	6V	10W	X		X	X	X